

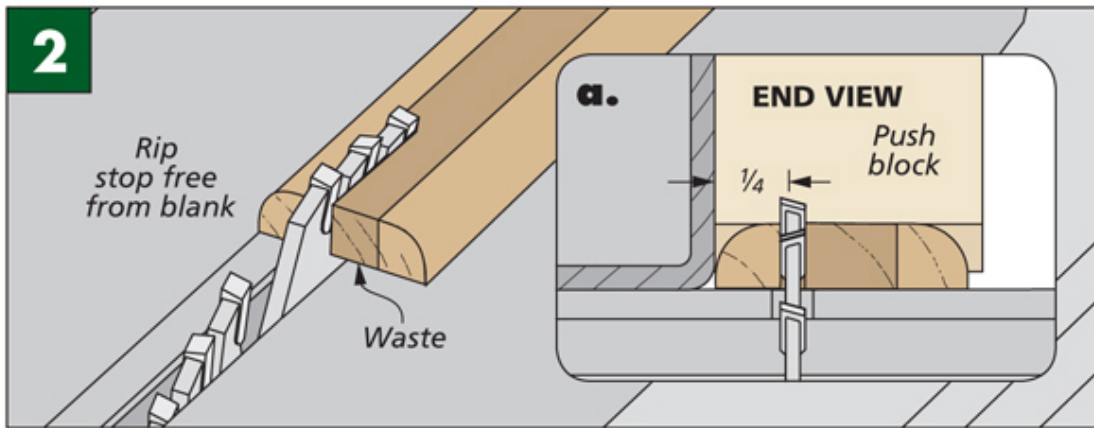

Whenever I make doors with glass panels, I use thin strips of wood called stop to hold the panels in the frame. The quarter round stop is mitered and tacked in place so they give the door a finished look. And if I ever need to replace the glass, the stop comes out easily.

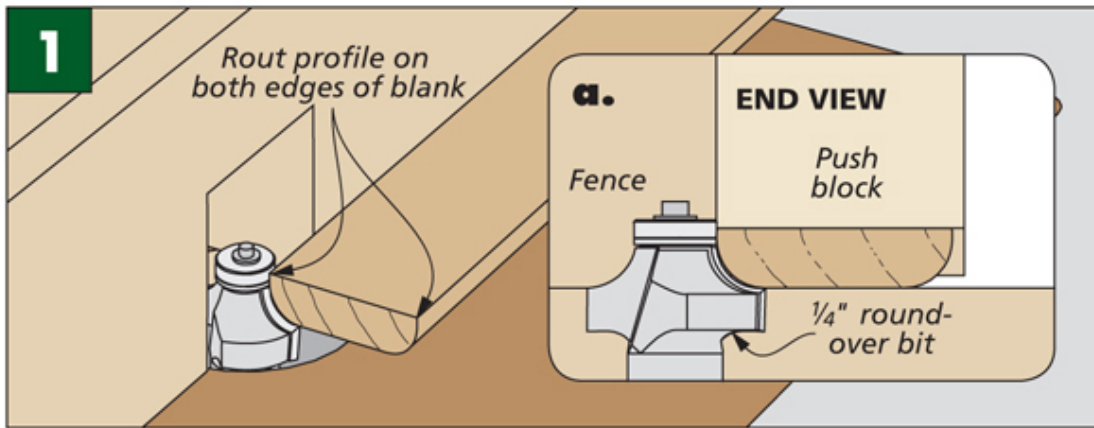

Start With a Blank

Working with pieces this thin and small can be a bit of a challenge, though. The secret is to start with a larger blank. To make this glass stop, I began by planing a wide blank to final thickness (1/8"). Once this was done, I routed a roundover on both edges of the blank. To complete the glass stop, I simply ripped it free from both edges of the blank at the table saw (Figure 2). A push block helps to safely guide the workpiece past the blade. Now it's ready to be cut and fit to the frames.